

ASAP FASTENING SYSTEMS, INC.

SUPPLIES FOR INDUSTRY AND CONSTRUCTION

2013 SOUTH 37TH STREET • MILWAUKEE, WISCONSIN 53215

(414) 344-4500 • FAX (414) 344-4504

WWW.ASAPFASTENING.COM • EMAIL: SALES@ASAPFASTENING.COM

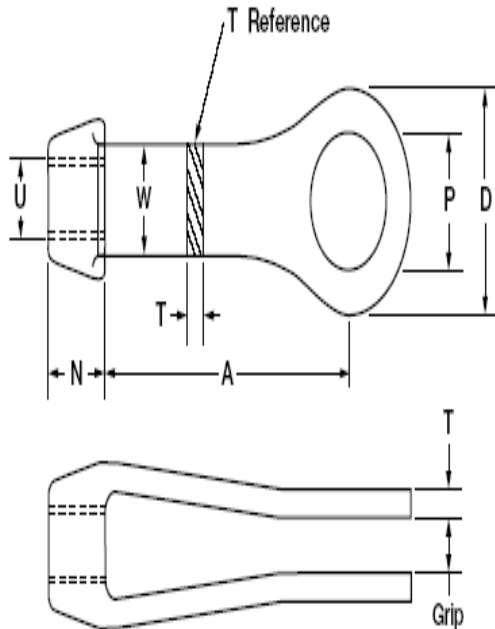

Table I: Standard Clevis Dimensions (Inches)

Clevis No.	D	N	Thd. Max. U	W	T	A	Pin Max. P	Rated Capacity (Lbs.)	Unit Wt. (Lbs.)
2	1 7/16	5/8	5/8	1 1/16	5/16 + 1/32-0	3 9/16	3/4	3500	1
2 1/2	2 1/2	1	7/8	1 1/4	5/16 + 1/32-0	4	1 1/2	7500	2 1/2
3	3	1 1/4	1 3/8	1 1/2	1/2 + 1/16-1/32	5 1/16	1 3/4	15000	4
3 1/2	3 1/2	1 1/2	1 1/2	1 3/4	1/2 + 1/16-1/16	6	2	18000	6
4	4	1 3/4	1 3/4	2	1/2 + 1/16-1/16	5 15/16	2 1/4	21000	9
5	5	2 1/4	2 1/8	2 1/2	5/8 + 3/32-0	7	2 1/2	37500	16
6	6	2 3/4	2 1/2	3	3/4 + 3/32-0	8	3	54000	26
7	7	3	3	3 1/2	7/8 + 1/8-1/16	9	3 3/4	68500	36
8	8	4	4	4	1 1/2 + 1/8-1/16	10 1/8	4 1/4	135000	90